

# SERVICE BULLETIN **Buell**<sup>®</sup>

B-018

May 13, 1999

**AMERICAN MOTORCYCLES**

## SAFETY RECALL CODE 0810 - FRONT ISOLATOR MOUNT SYSTEM

### GENERAL

Buell Motorcycle Company has learned that certain 1997 and 1998 Buell motorcycles were built with an isolator mount system that could lose clamp load. Should this condition occur, it may allow the engine to move unexpectedly in the frame and cause an unintended distraction to the operator, which could result in an accident. Accordingly, Buell Motorcycle Company is conducting a voluntary recall campaign to formally recall all potentially affected motorcycles.

This campaign involves all 1997 and 1998 S1 Lightning, S1 White Lightning, M2 Cyclone, S3 Thunderbolt and S3T Thunderbolt model Buell motorcycles manufactured between January 6, 1996 and June 16, 1998.

This condition will be remedied by replacing the front isolator mount system on all potentially affected vehicles.

### DEALER ACTION, AFFECTED VEHICLES

Buell Distribution Corporation has attached a complete list of all vehicles shipped to your dealership involved in this recall. To ensure the safety of all affected riders, it is your responsibility to perform the required service on all affected vehicles, even if the motorcycle was not purchased from your dealership.

If you are not sure that a safety recall has been completed on a particular Buell motorcycle, contact the recall information line at 1-800-448-1708. Recall information is also available on TALON and hd-net.com.

#### IMPORTANT NOTE

*Because only registered owners, as shown on the attached list, will receive notification from Buell Distribution Corporation, we request that you contact any owners of vehicles still listed as unregistered. Advise them of the safety recall and make arrangements for them to come in for recall service. We also require that you provide us with their names, addresses and V.I.N.s as soon as possible. This will enable us to mail them an owner's letter as required by National Traffic and Motor Vehicle Safety Act, as amended.*

Initial shipment of recall kits will begin on or before May 30, 1999. All kits will be shipped direct from the Franklin Distribution Center, no charge, transportation paid. To order the remainder of kits that may be needed, please fill out the attached order form and send/fax it to the Warranty Department at (FAX) 414-343-8346.

Buell Distribution Corporation reserves the right to conduct wave shipments in lieu of processing orders and/or adjusting order quantities, depending on the availability of parts.

The domestic (US, Canada, Japan and New Zealand) front isolator mount system recall kit (Part No. 93916Y) consists of:

- Front Isolator Mount
- (2) Front Isolator Mount Bolts
- (2) Front Isolator Mount Thick Washers
- Isolator Locknut
- Cable Tie (for fuel tank vent hose)
- Hose Clamp (for fuel tank hose to fuel supply valve)

### INSTALLATION

#### NOTE

- Perform the following procedures according to the guidelines given in the service manual for the model being serviced.
- The fuel tank must be removed from S3, S3T and S1W models to perform this service. The fuel tank does not need to be removed from S1 and M2 models.

### S3/S3T/S1W Models

1. Position motorcycle on a suitable lift and position REAR WHEEL SUPPORT STAND (Part No. B41174) under the swing arm. Secure motorcycle to lift.

#### WARNING

**Always disconnect the negative battery cable when working on motorcycle to prevent accidental startup. If the positive cable should contact ground with the negative cable installed, the resulting sparks may cause a battery explosion, which could result in death or serious injury.**

2. Disconnect negative battery cable.
3. Remove seat and fuel tank. See appropriate service manual, Section 4 for procedure.
4. Remove airbox cover (and left fairing lower on S3Ts) and filter box.
5. Remove two nuts and 2 socket head screws from air cleaner backplate and front isolator mount.
6. Position floor jack under engine under front shock mount to support engine.
7. Remove and discard isolator locknut and remove bolt, two washers and D washer.

ROUTING	SERVICE MANAGER	SALES MANAGER	PARTS MANAGER	LEAD TECHNICIAN	TECHNICIAN NO. 1	TECHNICIAN NO. 2	TECHNICIAN NO. 3	TECHNICIAN NO. 4	RETURN THIS TO:
INITIAL HERE									

8. Remove and discard two bolts and washers from left and right side of front isolator mount.
9. Remove front isolator mount from left side of motorcycle.

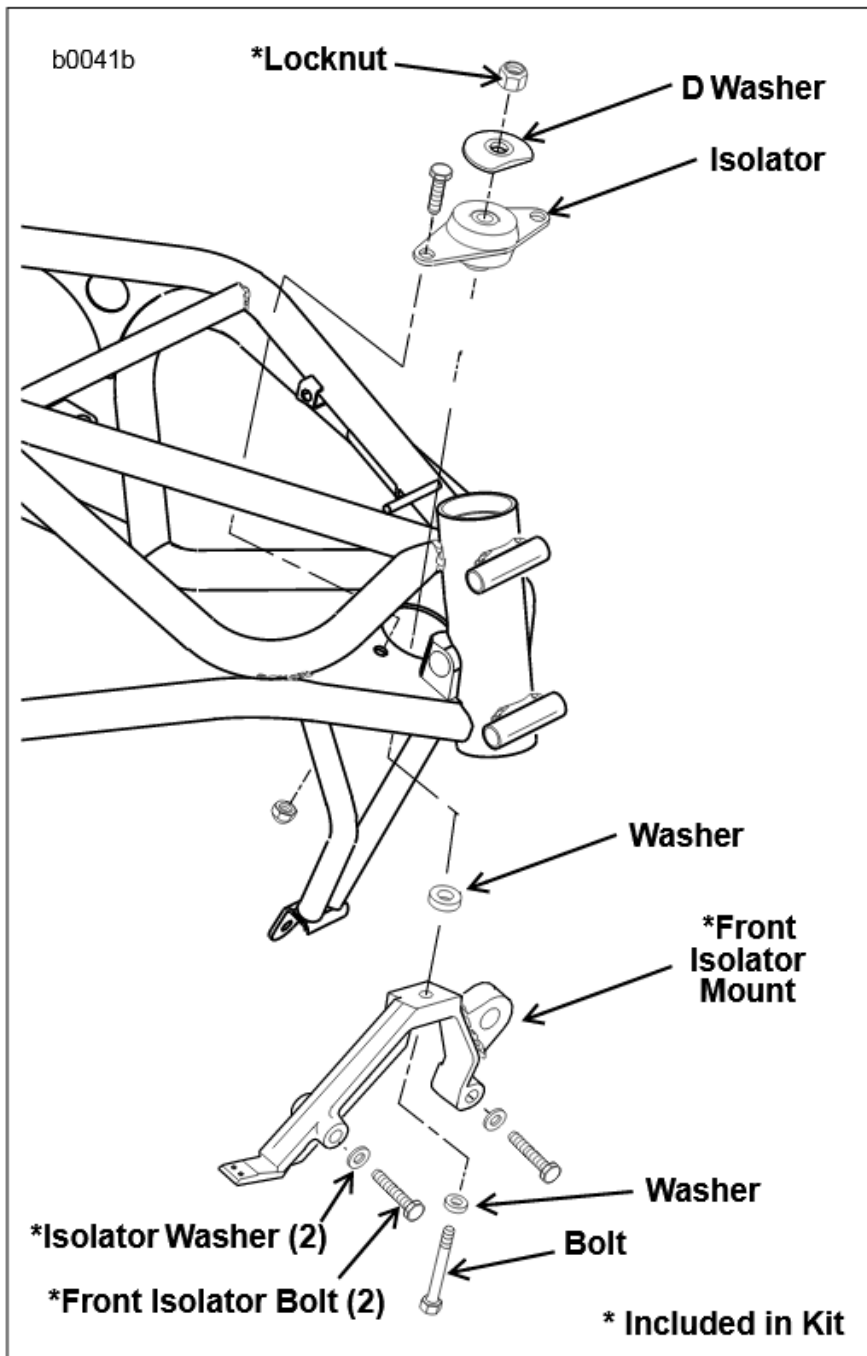

Figure 1. Front Isolator Mount

### WARNING

Always wear proper eye protection and gloves when working with compressed air. Debris or solvent may be blown out with enough force to penetrate skin or cause eye injury. Failure to comply could result in death or serious injury.

10. Clean residual loctite from threads in engine with a suitable nonflammable solvent and dry with compressed air.
11. Apply LOCTITE THREADLOCKER 271 (red) to threads of **new** front isolator mount bolts.
12. Apply a thin film of clean HD 20W50 engine oil to both sides of **new** thick washers and to bottom of bolt heads. Exercise caution to avoid mixing oil on washers with loctite on bolts.
13. Position **new** front isolator mount and secure with two **new** front bolts with **new** thick washers. Tighten bolts to 60 ft-lbs (81 Nm) initially and then loosen each bolt one full turn. Tighten bolts again to 60 ft-lbs (81 Nm).

### NOTE

Make sure flat on D washer remains oriented to front of motorcycle while tightening bolt.

14. Position washer between front isolator mount and isolator. Install bolt, washer, D washer and **new** locknut.
15. Making sure flat on D washer stays oriented to front of bike, tighten bolt to 100 ft-lbs (135.6 Nm).
16. Apply LOCTITE THREADLOCKER 243 (blue) to threads of airbox screws. Install airbox screws to airbox and front isolator mount. Install locknuts to screws.
17. Install air cleaner filter box and cover.
18. Connect negative battery cable.
19. Install fuel tank and seat.

On motorcycles with original fuel tank mounting hardware tighten fuel tank hardware to specification listed below:

- 9-11 ft-lbs (12.2-14.9 Nm)

On motorcycles that have had the fuel tank retention recall service performed, make sure plates are oriented properly and tighten fuel tank hardware to specification listed below:

- 18-23 ft-lbs (24.4-31.2 Nm), then wait 3-5 minutes and tighten again to 18-23 ft-lbs (24.4-31.2 Nm).

### WARNING

After installing seat, pull upward on front of seat to be sure it is locked in position. If seat is loose, it could shift during vehicle operation and startle the rider, causing loss of control. These events could result in death or serious injury.

### NOTE

A **new** cable tie and **new** hose clamp have been provided in the kit to install the fuel tank vent hose and supply hose.

## S1/M2 Models

1. Position motorcycle on a suitable lift and position REAR WHEEL SUPPORT STAND (Part No. B41174) under the swing arm. Secure motorcycle to lift.

### WARNING

Always disconnect the negative battery cable when working on motorcycle to prevent accidental startup. If the positive cable should contact ground with the negative cable installed, the resulting sparks may cause a battery explosion, which could result in death or serious injury.

2. Disconnect negative battery cable.
3. Position floor jack under engine under front shock mount to support engine.
4. From left side of motorcycle, remove and discard isolator locknut and remove bolt, two washers and D washer.
5. Remove air cleaner cover and filter box.
6. Remove two nuts and 2 socket head screws from air cleaner backplate and front isolator mount.
7. Remove and discard two bolts and washers from left and right side of front isolator mount.
8. Remove front isolator mount from left side of motorcycle.

## ⚠️ WARNING

Always wear proper eye protection and gloves when working with compressed air. Debris or solvent may be blown out with enough force to penetrate skin or cause eye injury. Failure to comply could result in death or serious injury.

- Clean residual loctite from threads in engine with suitable nonflammable solvent and dry with compressed air.
- Apply LOCTITE THREADLOCKER 271 (red) to threads of **new** front isolator mount bolts.
- Apply a thin film of clean HD 20W50 engine oil to both sides of **new** thick washers and to bottom of bolt heads. Exercise caution to avoid mixing oil on washers with loctite on bolts.
- Position **new** front isolator mount and secure with two **new** front bolts with **new** thick washers. Tighten bolts to 60 ft-lbs (81 Nm) initially and then loosen each bolt one full turn. Tighten bolts again to 60 ft-lbs (81 Nm).

### NOTE

- Make sure flat on D washer remains oriented to front of motorcycle while tightening bolt.*
  - A needle nosed pliers can be used to position the locknut over the bolt.*
- Position washer between front isolator mount and isolator. Install bolt, washer, D washer and **new** locknut.
  - Making sure flats on D washer stay oriented to front of bike, tighten bolt to 100 ft-lbs (135.6 Nm).
  - Apply LOCTITE THREADLOCKER 243 (blue) to threads of two air cleaner backplate screws. Install two screws to air cleaner backplate and front isolator mount. Install locknuts to screws.
  - Install air cleaner filter box and cover.
  - Connect negative battery cable.

## CREDIT PROCEDURES - VEHICLE REPAIR

For each vehicle serviced, place a "C" in the letter box on the Buell Dealer Service Card. Destroy and discard the original isolator mount and hardware. Send the properly completed dealer service cards to Buell Distribution Corporation. Upon receipt and processing of your properly completed dealer service cards, you will be credited for 1.4 hours for M2, S1, S1W and S3 models and 1.6 hours for S3T models. Both times include 0.1 hour administrative time and your cost for loctite. No credit will be issued for the kits as they were sent no charge, transportation paid.

## CREDIT PROCEDURES - DEALER STOCK PARTS

Remove all affected front isolator mounts (Part Nos. 16271-97Y and 16298-97Y) from your inventory. To receive credit, complete a regular warranty claim referencing Service Bulletin B-018 in the "Description of Repair" section. Fill in the rest of the claim as follows.

**Table 1. Credit for Parts**

Claim Type	BDS
Quantity	See Note Below
Event 1, Problem Part No.	16271-97Y (Domestic)
Event 2, Problem Part No.	16298-97Y (International)
Part Description	Isolator Mount
Customer Concern Code	9205
Condition Code	9111

### NOTE

*"Quantity" and "Problem Part" may vary depending upon what you have in stock. If you happen to have both isolator mounts in stock, list two separate events on the claim as demonstrated above.*

Upon receipt of properly completed claim for parts in dealer stock, you will receive the appropriate credit for parts. DESTROY AND DISCARD ALL AFFECTED PARTS FROM YOUR STOCK. Buell Distribution Corporation will advise at a later date how to order updated isolator mounts to replenish your stock. DO NOT ORDER THE RECALL KITS TO RESTOCK YOUR INVENTORY!

