

-J05029

REV. 2009-11-06

1125R SIDE FAIRING, BLACK

GENERAL

Kit Number

M2296.1AMMW

Models

For the most up-to-date model fitment information, See product label or www.buell.com (English only).

Kit Contents

See and Table 2.

INSTALLATION

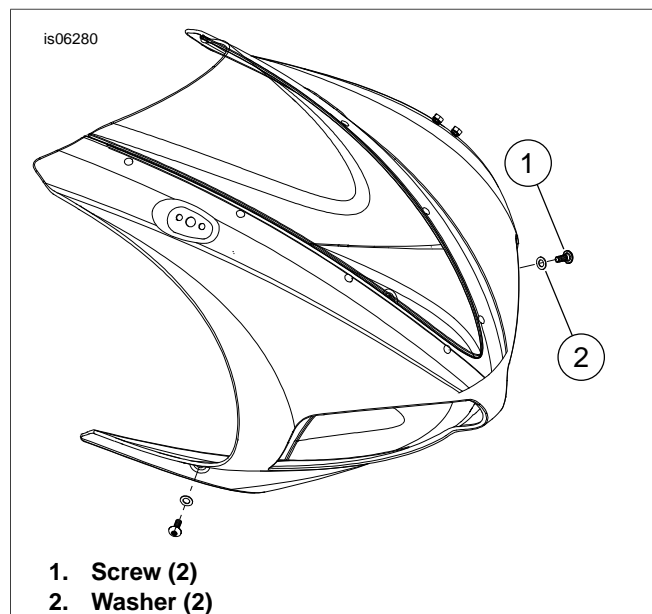

Figure 1. Remove Fairing Lower Screws and Washers

1. See Figure 1. Remove the lower right and left screws and washers from the front fairing.
2. See Figure 2. On lower left side remove screw (4) from ignition cover and install the bracket (2) with the tab stop shown. Use the screw (4) for installing the bracket. Tighten screw to 97 **in-lbs** (10.9 Nm).

NOTE

2009 and later models will use the spacer (CH0039.1AM) for the lower left front bracket.

3. On lower left side remove screw (5) and install front bracket (1) and install bolt (5). This bracket does not have a tab stop and may require some adjustment for proper alignment to the fairing. When aligned, tighten to 97 **in-lbs** (10.9 Nm).
4. Install speed clip nuts (3) to both brackets as shown.

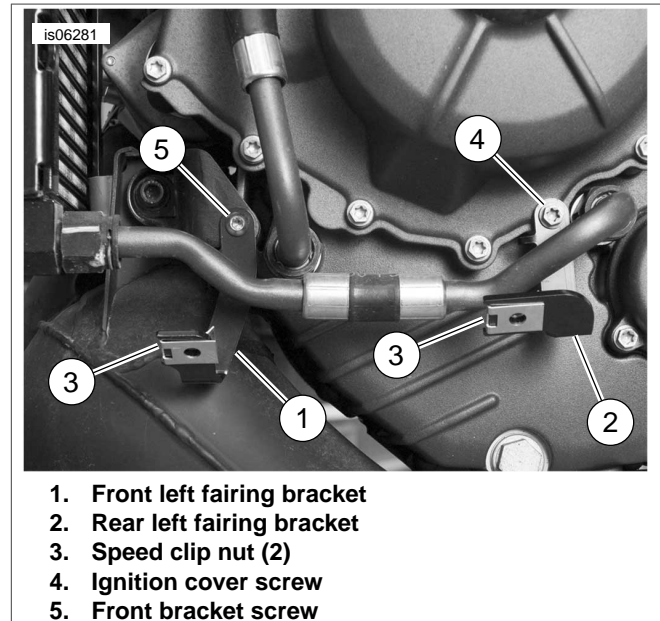

Figure 2. Installing Brackets for Lower Left Fairing

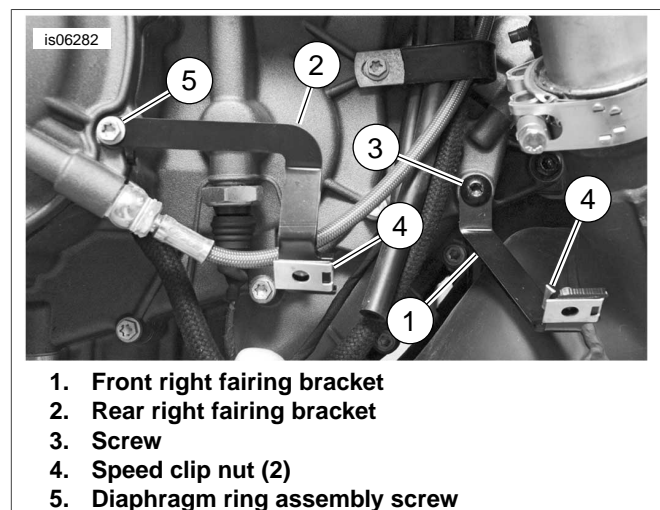

Figure 3. Installing Brackets for Lower Right Fairing

5. See Figure 3. On the lower right side remove screw (5) from the diaphragm ring assembly and install the bracket (2) with the tab stop. Install the screw previously removed and tighten the screw to 97 **in-lbs** (10.9 Nm).
6. The lower right front bracket attaches to a threaded engine boss as shown. Using the kit M6-1.0 x 14 TORX® screw, attach the bracket. This bracket does not have a tab stop and may require some adjustment for proper alignment to the fairing. When aligned tighten to 97 **in-lbs** (10.9 Nm).

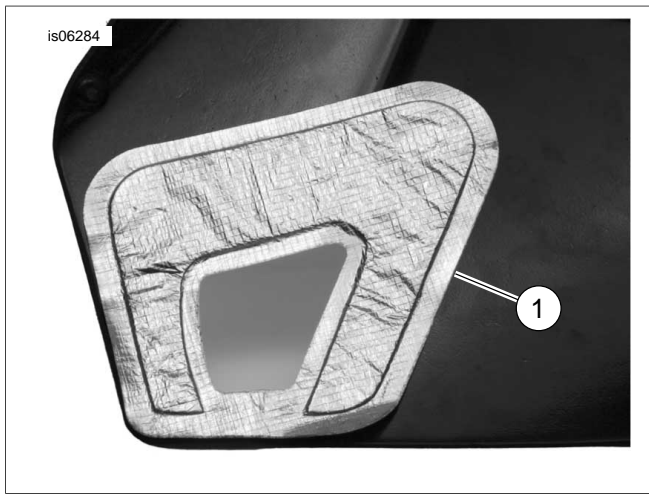
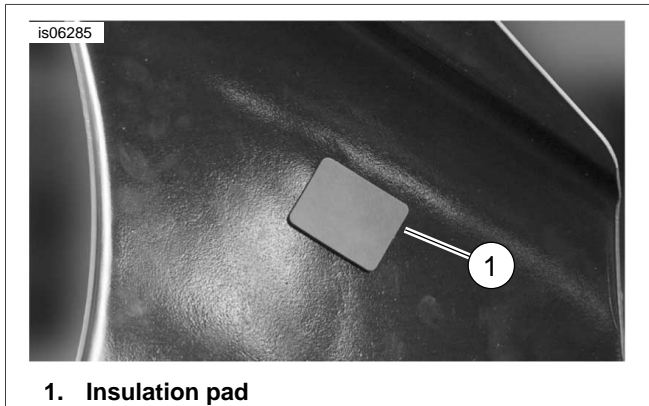
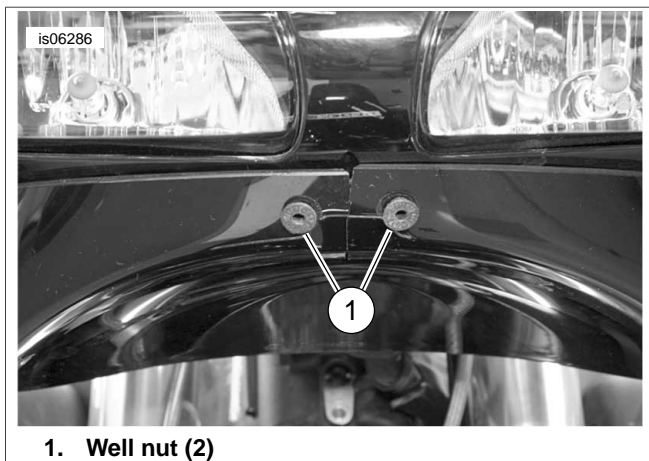

Figure 4. Install Heat Tape to Right Fairing



1. Insulation pad

Figure 5. Install Insulation Pad to Right Fairing



1. Well nut (2)

Figure 6. Install Well Nuts to Front of Fairings

7. Install the speed clip nuts (3) to both brackets as shown.
8. See Figure 4. Install the heat tape around the cutout on the inside of the right side fairing.
9. See Figure 5. Install the insulation pad to each fairing lower in the location scribed on the inside of each fairing lower.
10. Install the right and left lower fairings to the brackets using the black buttonhead TORX shoulder bolts and nylon washers.

11. See Figure 6. Install the well nuts to the front of the left and right fairings.

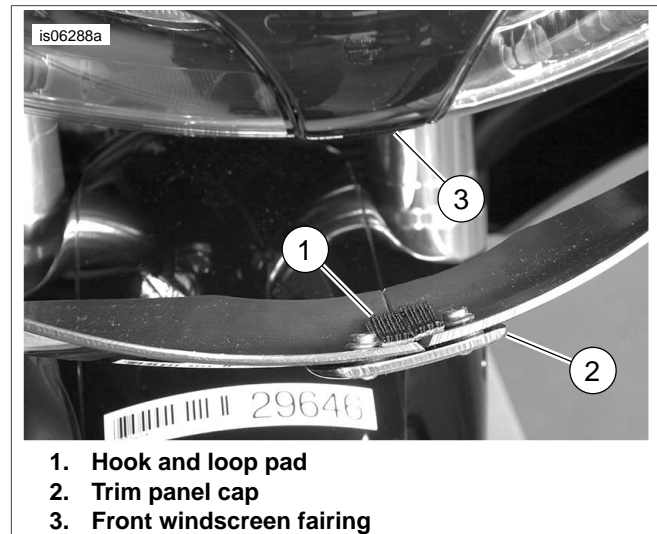

- 1. Hook and loop pad**
- 2. Trim panel cap**
- 3. Front windscreen fairing**

Figure 7. Install Hook and Loop Pads

12. See Figure 7. Attach the black trim panel cap (2) to the well nuts using the 6-32 x 1/2 inch stainless steel button-head screws. Tighten screws to 10-12 **in-lbs** (1.1-1.4 Nm).
 - a. Remove backing from the two smaller hook and loop pads (1). Attach one piece to each fairing backside.
 - b. Attach the larger hook and loop pad to the installed pads and press firmly to attach the adhesive side to the front fairing (3).

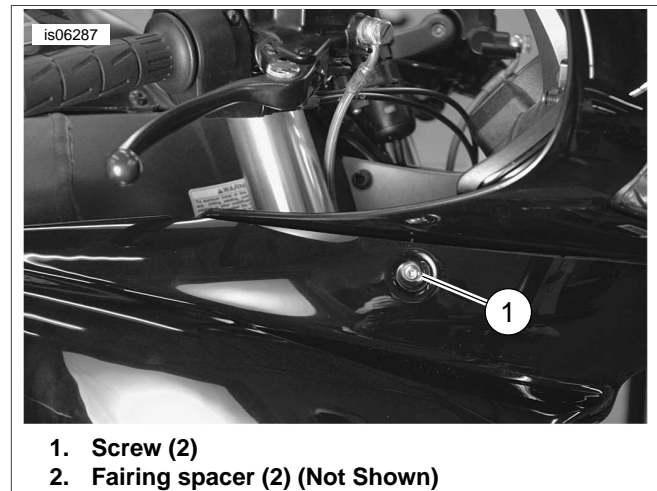

- 1. Screw (2)**
- 2. Fairing spacer (2) (Not Shown)**

Figure 8. Install Top Screws to Side Fairings

13. See Figure 8. Insert the 6 x 1 x 30 mm screw and insert through the hole at the top of the right fairing. Slide a spacer over the screw and install the screw through the front fairing where the original screw was removed. Tighten screw to 72-84 **in-lbs** (8.1-9.5 Nm).
14. Repeat step 13 for the left side fairing.
15. Make a final check for clearance between the right side fairing and the exhaust pipes. If they are touching the exhaust you will need to loosen and adjust the lower fairing brackets to gain a minimum of 1/4 inch of clearance.

Table 1. Cleaning Solarkote Fairing Panels for Painting

Type of Contamination	Cleaning Method
*Note: When a clean-water rinse is specified, use distilled or deionized water to prevent water spotting, which may adversely affect adhesion.	
Masking Paper Adhesive	Dab with the gummed surface of the masking paper. If this fails, wipe with naphtha on a clean cloth and rinse with dilute water-detergent solution, or wipe with 99% isopropyl alcohol and rinse with clean water.*
Water-soluble Contaminants	Wash with a detergent-water solution followed by a fresh-water rinse.
Fingerprints	Wipe with a soft clean cloth dampened with 99% isopropyl alcohol.
Oil-soluble Contaminants	Use a hydrocarbon solvent such as naphtha, kerosene or mineral spirits. Follow with a detergent-water wash and a clean-water* rinse.
Spray-masking Compounds	Wipe the area with a damp synthetic sponge, then wipe the surface with naphtha or isopropyl alcohol.
Grease-forming Compounds	Wash with kerosene or mineral spirits. Follow by washing with a detergent-water solution and a clean-water* rinse.
Silicone Oils and Greases	Avoid contact completely. Once contaminated with silicones, Solarkote® is virtually impossible to clean.

SERVICE PARTS

Table 2. Service Parts Table

Item	Description (Quantity)	Part Number
1	Foam pad, adhesive backed, windscreen (2)	M0333.T
2	Insulation pad	C0587.1AM
3	Hook and loop fastener, black, 3/4 x 1 inch	C1025.1AM
4	Hook and loop fastener, black, 3/8 x 1 inch (2)	C1026.1AM
5	Screw, M6-1.0 x 14, T30 head	CA0023.1AM
6	Shoulder screw, M6, T30 head (4)	CA0030.1AMA
7	Button head screw, stainless steel, 6-32 x 1/2 inch (2)	CA0124.1AM
8	Screw, 6 x 1 x 30 mm (3)	CA0125.1AM
9	Nylon washer, 5/16 X 9/16 nylon (4)	BA0509.6
10	Speed clip nut, M6 (4)	CD0022.1AM
11	Well nut, 6-32 (2)	CD0052.1AM
12	Fairing spacer (2)	CH0039.1AM
13	Spacer (2009 & later)	CH0040.1AM
14	Left side fairing bracket, front	M0280.1AM
15	Right side fairing bracket, front	M0281.1AM
16	Left side fairing bracket, rear	M0282.1AM
17	Right side fairing bracket, rear	M0283.1AM
18	Right side fairing, black	M0297.1AMMW
19	Left side fairing, black	M0298.1AMMW
20	Trim panel cap, black	M0370.1AMMW