

**NOTE**

*Push rod cover must be installed prior to installing cylinder head.*

1. See [Figure 3-64](#). Install push rod cover.
  - a. Install **new** o-rings (2) on top of each push rod cover (3).
  - b. Install **new** push rod cover gasket (5) onto bottom of each push rod cover.
  - c. Install push rod cover assembly and start the four fasteners (4) securing bottom of cover to crankcase.
  - d. Tighten fasteners to 30-40 **in lbs** (3.4-4.5 Nm).
2. Refer to [Table 3-23](#). Identify push rod color coding, length and respective push rod positions in engine. Place intake and exhaust push rods onto seat at top of tappet.

**Table 3-23. Push Rod Selection**

POSITION	COLOR CODES	LENGTH	PART NO.
Exhaust	1 Band- Black	10.969 in. (278.613 mm)	17985-00Y
Intake	1 Band- Green	10.915 in. (277.241 mm)	17984-00YA

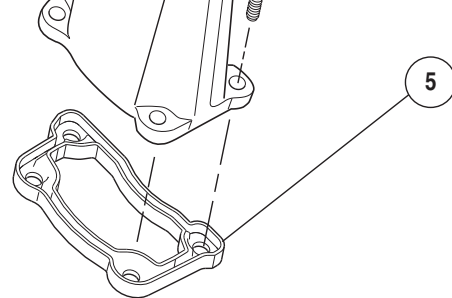

1. **Push rod (2)**
2. **O-ring (2)**
3. **Push rod cover**
4. **Screws (4)**
5. **Push rod cover gasket**

**Figure 3-65. Push Rods and Push Rod Cover Assembly**